

รายการวัสดุอุปกรณ์ระบบสปริงเกอร์

ระบบท่อน้ำ ท่อร้อยสายไฟและข้อต่อ



เอส.เค.ไพพ์

ท่อน้ำ HDPE

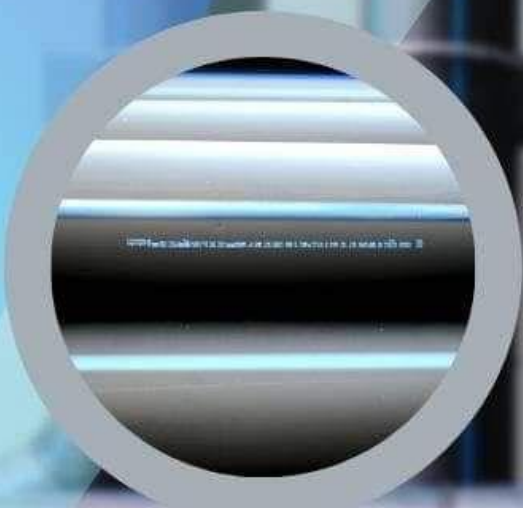

✓ 10
BARS

✓ 6
BARS

- ✓ ทนแรงดันสูง
- ✓ น้ำหนักเบา แข็งแรง เหนียว ยืดหยุ่นได้ดี
- ✓ มีสารป้องกัน UV ทนต่อแสงแดด ไม่เกิดตะไคร่ ไม่เกิดตะกรัน ไม่เป็นสนิม
- ✓ ของเหลวไหลผ่านได้ดี
- ✓ เป็นมิตรกับสิ่งแวดล้อม

" คุณภาพระดับHIGH
ใช้ได้สบายๆ ไม่แตกหักง่าย "



เอส.เค.ไพพ์
ประเทศไทย



TON
COMPRESSION FITTING
 FOR HDPE PIPE BRAND TON-D

HDPE เชื่อมต่อ HDPE แบบสวมอัด ทนแรงดันสูง

เชื่อมต่อ ทนแรงดันสูง

เชื่อมต่อตรง
STRAIGHT COUPLING



ข้องอ 90°
90° ELBOW



เชื่อมต่อตรง
 เกลียวนอก
MALE COUPLING



- ข้อต่อตรง
- ข้อต่อตรงเกลียวใน
- ข้องอเกลียวใน 90°
- ข้อต่อตรงลด
- ข้องอ 90°
- ฝาอุดปลายท่อ
- ข้อต่อตรงเกลียวนอก
- ข้องอเกลียวนอก 90°
- สามทางเกลียวใน
- สามทางลดสามทาง, ปะแจขันฝาแคป

Size mm.

20	25	32	40	50
63	75	90	110	



แกล้มปิดรั่วแยก



Sprinkler Pop up spray R=2-5 м. HUNTER PSU



- 01 **Slim:** With a sleek, durable body, the PS Ultra performs well in tight spaces
- 02 **Compatible:** Works with all nozzles for easy retrofitting
- 03 **Versatile:** PS Ultra is available in an array of sizes and pre-inserted nozzle options

PS ULTRA SLIM-LINE SPRAY SPRINKLER

PS Ultra Is the Slim Spray with Essential Features for Any Installation

Perfect for standard residential applications, this compact, slim-line spray sprinkler comes in 5 cm, 10 cm, and 15 cm models. Its innovative body incorporates a reliable two-piece ratchet, durable cap, male-threaded riser, and large filter screen, providing double filtration on 10 cm and 15 cm models. Additionally, the 5 cm and 10 cm models are retro-compatible with existing PS Spray bodies, which allows for a quick and easy upgrade. Standard PS Ultra models include a pre-installed Pro Adjustable Nozzle. A Flush Plug version is available without a nozzle or filter screen. With a range of compatible nozzles to choose from, finding the most efficient solution for any application is simple.

PS ULTRA FEATURES & SPECIFICATIONS

Features

- Application: Residential
- Models: 5 cm, 10 cm, 15 cm
- Nozzle choices: 2.4 m, 3.0 m, 3.7 m, 4.6 m, 5.2 m, 1.5 x 9.0 m side strip (side strip pattern available on 5 cm and 10 cm models only)
- Optional preinstalled Pro Adjustable Nozzle
- Enhanced cap for more durability, easier handling, and extended riser seal life
- 5 cm and 10 cm models can retrofit into older-style PS sprays
- Two-piece ratchet for reliable riser adjustment
- Male-threaded riser to accept all female nozzles
- Available with flush plug (large filter screen not included)
- Optional extra-large filter screen
- Warranty period: 2 years

Specifications

- Recommended pressure range: 1.4 to 4.8 bar; 140 to 480 kPa
- Flow rate: 0.72 to 21.75 l/min; 0.04 to 1.30 m³/hr
- Radius: 2.2 m to 5.8 m
- Precipitation rates: 35 to 42 mm/hr approx.

PS ULTRA - SPECIFICATION BUILDER: ORDER 1 + 2 + 3 (OPTIONAL)

1	Model	2	Nozzles	3	Optional
	PSU-02 = 5 cm pop-up		(blank) = Flush plug, no large filter screen		NFO = Nozzle filter only <i>(Available for 10 cm model only)</i>
	PSU-04 = 10 cm pop-up		8A = 2.4 m adjustable nozzle		
	PSU-06 = 15 cm pop-up		10A = 3.0 m adjustable nozzle		
			12A = 3.7 m adjustable nozzle		
			15A = 4.6 m adjustable nozzle		
			17A = 5.2 m adjustable nozzle		
			5SS = 1.5 m x 9.0 m side strip <i>(not available for PSU-06)</i>		

Examples:

- PSU-04 - 15A = 10 cm pop-up with a 4.6 m adjustable nozzle
- PSU-02 - 5SS = 5 cm pop-up with a 1.5 m x 9.0 m side strip
- PSU-06 - 10A = 15 cm pop-up with a 3.0 m adjustable nozzle
- PSU-04 - 12A - NFO = 10 cm pop-up with a 3.7 m adjustable nozzle, nozzle filter only

Models

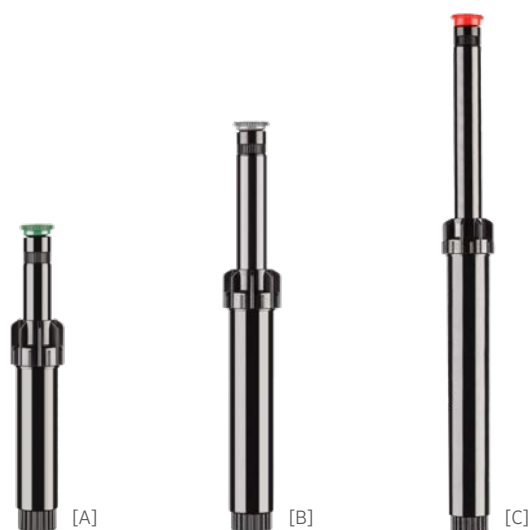

[A] PSU-02

Overall height: 12 cm
Pop-up height: 5 cm
Exposed diameter: 3 cm
Inlet size: ½"

[B] PSU-04

Overall height: 18 cm
Pop-up height: 10 cm
Exposed diameter: 3 cm
Inlet size: ½"

[C] PSU-06

Overall height: 24 cm
Pop-up height: 15 cm
Exposed diameter: 3 cm
Inlet size: ½"

DIRECTIONAL FLUSH PLUG

The PS Ultra comes equipped with a flush plug when ordered standard without a nozzle. The PS Ultra flush plug is directional, allowing the user to avoid uncontrolled flooding of the head area.



Website hunterindustries.com | Customer Support +1 760-752-6037 | Technical Service +1 760-591-7383

Helping our customers succeed is what drives us. While our passion for innovation and engineering is built into everything we do, it is our commitment to exceptional support that we hope will keep you in the Hunter family of customers for years to come.

Gene Smith

Gene Smith, President, Landscape Irrigation and Outdoor Lighting

HUNTER - Timer X-CORE 6 Zone 24 VAC พร้อมตุ๊ก นน้ำ



- 01 Smart:** Save water and money by installing a Solar Sync® weather sensor
- 02 Versatile:** Up to 8 stations with 3 programs and 4 start times each
- 03 Maintenance:** Cycle and Soak, Seasonal Adjust, and other water-saving features

X-CORE RESIDENTIAL CONTROLLER

Residential Control Starter Solution for Advanced Water Savings

This entry-level residential controller offers simple operation with Solar Sync compatibility. With easy-to-configure control for up to 8 stations, including 3 programs and 4 start times each, the X-Core is the perfect solution for residential applications. Install the revolutionary Solar Sync ET sensor to regulate irrigation run times based on locally measured weather. X-Core is also compatible with Hunter remotes for quick, wireless activation of irrigation. Installation, operation, and maintenance are designed to be simple while still delivering optimal efficiency and reliability.

Add a Remote, Enhance Convenience

Adding a ROAM remote allows for controller operation up to 300 m away.



ROAM

Add a Weather Sensor, Save Water and Money

Solar Sync ET sensor saves water and money by adjusting irrigation run times based on local weather and stopping irrigation during rain events.



WSS-SEN

X-CORE FEATURES & SPECIFICATIONS

Features

- Number of stations: 2, 4, 6, 8
- Type: Fixed
- Enclosures: Indoor and outdoor
- Independent programs: 3
- Start times per program: 4
- Max. station run time: 4 hours
- Easy Retrieve™ Memory
- Hunter Quick Check™
- Programmable Rain Delay
- Sensor Bypass
- Delay Between Stations
- Cycle and Soak
- Warranty period: 2 years

Specifications

- Transformer input: 120 VAC or 240 VAC (international model)
- Transformer output (24 VAC): 1 A
- Station output (24 VAC): 0.56 A
- Pump/master valve (24 VAC): 0.28 A
- Sensor inputs: 1

Approvals

- CE, UL, cUL, C-tick, FCC

X-CORE – SPECIFICATION BUILDER: ORDER 1 + 2 + 3 +			
1	Models	2 Transformer	3
	XC-2 = 2 stations <i>(indoor model only)</i>	00 = 120/VAC 01 = 240 VAC	(bl 1. ha wi i =
	XC-4 = 4 stations		
	XC-6 = 6 stations		
	XC-8 = 8 stations		

Examples:

XC-201i - E = 2-station 240 VAC indoor controller, with plastic cabinet
 XC-401 - E = 4-station 240 VAC outdoor controller, with plastic cabinet
 XC-601i - E = 6-station 240 VAC indoor controller, with plastic cabinet
 XC-801 - E = 8-station 240 VAC outdoor controller, with plastic cabinet

Models

PLASTIC INDOOR

Height: 16.5 cm
 Width: 14.6 cm
 Depth: 5 cm



PLASTIC OUTDOOR

Height: 22 cm
 Width: 17.8 cm
 Depth: 9.5 cm



ตู้ควบคุมโซลินอยด์วาล์ว 8 โซน + ปุ่มน้ำขนาด 1-3 แรงม้า 220VAC



- มีระบบป้องกันปุ่มน้ำ Run dry ไม่ให้ปุ่มทำงานด้วเปล่า
- มีระบบให้ปุ่มน้ำทำงานช้ากว่าโซลินอยด์วาล์ว เพื่อไล่อากาศในเส้นท่อ

Website hunterindustries.com | Customer Support +1 760-752-6037 | Technical Service +1 760-591-7383

Helping our customers succeed is what drives us. While our passion for innovation and engineering is built into everything we do, it is our commitment to exceptional support that we hope will keep you in the Hunter family of customers for years to come.

Gene Smith, President, Landscape Irrigation and Outdoor Lighting

-RAIN - Solenoid valve ขนาด 1.5 นิ้ว 24VAC + Fitting valve

RAIN RN 160 PLUS

Technical Features

- PA 6 30% fiberglass
- Self cleaning stainless-steel metering pin
- Stainless-steel diaphragm differential spring for smooth closing
- Flow control
- Solenoid certificate CE, IP 68 9
- PN12 tested piece by piece at 14 bar
- Bleed handle for manual opening with internal bleed
- Energy efficient solenoid 0,2 amp, 4,8 VAC

**Operating Conditions**

- Pressure: min 1.0 bar - max 12.0 bar
- Temperature: +4° C/70° C

Available Versions

- Standard solenoid: 24 VAC
- Available solenoid 12 VDC; 24 VDC; 110 VAC; 9 VDC Latching
- On request are also available NPT thread versions: 1"1/2 NPT W/FC or 2" NPT W/FC

TECHNICAL FEATURES

- 1 Bleed handle for manual opening
- 2 Different threads available: female, male x union
- 3 Assembled diaphragm
- 4 Flow control adjustment handle

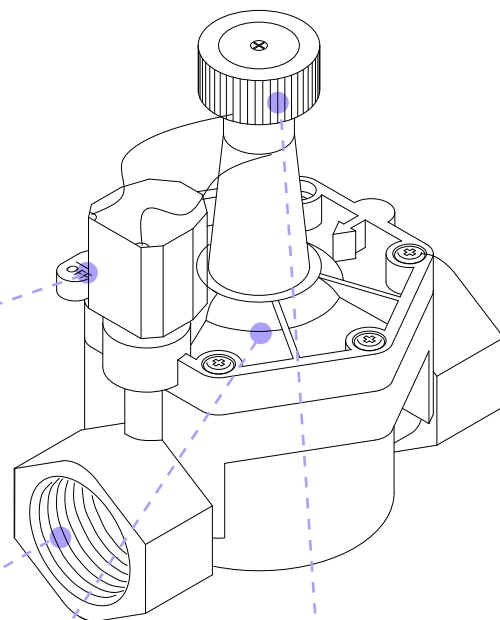

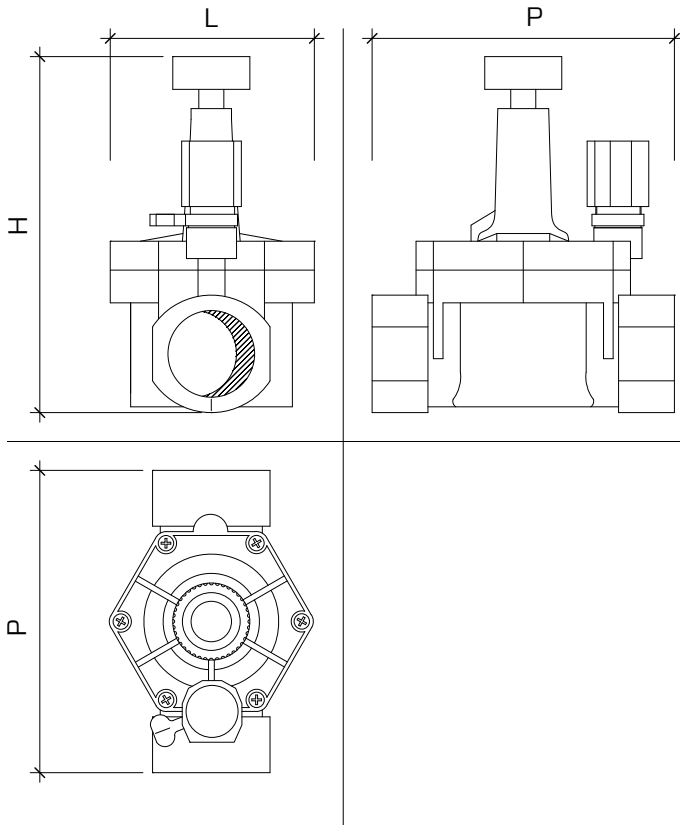

DIMENSIONS *

	1" F	1"1/4 F	1"1/2 F	2" F	1"1/2 MxU	2" MxU
H	18.4	18.4	18.4	18.4	18.4	18.4
P	14.5	14.8	15.7	18.3	16.5	17.5
L	10.6	10.6	10.6	10.6	10.6	10.6

*In cm.

LOSS OF CHARGE * *

	1"	1"1/4	1"1/2	2"
75 l/min	0.20	0.20		
100 l/min	0.27	0.20	0.20	0.16
125 l/min	0.32	0.21	0.20	0.16
150 l/min	0.42	0.27	0.20	0.16
175 l/min	0.58	0.30	0.21	0.18
200 l/min	0.75	0.40	0.25	0.21
225 l/min		0.48	0.29	0.23
250 l/min		0.58	0.34	0.28
275 l/min		0.69	0.39	0.32
300 l/min			0.45	0.38
325 l/min				0.41

**In bar.



Cod.	Models	Carton Qty	Carton Size [cm]	Carton Weight [kg]	Pallet Qty	Pallet Size [cm]	Pallet Weight [kg]
100.5700911	RN 160 PLUS 1" F W/FC	12	49x48x22	9.2	300	80x120x170	230
100.5701211	RN 160 PLUS 1"1/4 F W/FC	12	49x48x22	9.2	300	80x120x170	230
100.5701511	RN 160 PLUS 1"1/2 F W/FC	12	49x48x22	9.2	300	80x120x170	230
100.5701711	RN 160 PLUS 2" F W/FC	8	49x48x22	6.4	200	80x120x170	160
100.5701516	RN 160 PLUS 1"1/2 MxU W/FC	12	49x48x22	9.2	300	80x120x170	230
100.5701716	RN 160 PLUS 2" MxU W/FC	8	49x48x22	6.4	200	80x120x170	160

N.B. All valves are packed in single plastic bag

SPARE PARTS

Cod.	Models	Cod.	Models
103.1603050	DIAPHRAGM	103.1904000	SPRING
103.1601000	UPPER BODY WITH FLOW CONTROL	101.1001101	SOLENOID 24 VAC WITH PLUNGER AND ADAPTOR

-เครื่องสูบน้ำ 3.0 HP. 380V.

ACM/ WCM-Series Medium Head Centrifugal Pump

ปั๊มน้ำหอยโข่ง ชนิดแรงดันสูงปานกลาง



ACM-755TH



WCM-1505S



WCM-2205FS

Performance Range

- Power up to 5 HP (3.7 kW.)
- Flow Rate up to 500 l/min.
- Total Head up to 43 m.

- For 3 phase mode, able to switch to 220V to apply with inverter and solar panel easily.
- สำหรับรุ่น 3 เฟส สามารถสลับสายไฟเพื่อให้กลายเป็นระบบไฟฟ้า 220 โวลต์ สำหรับใช้งานร่วมกับอินเวอร์เตอร์และแผงโซลาร์ได้

Application

- Supply water for irrigation, sprinkler system for agriculture. Suitable for making automatic water system with high pressure supply for apartment hotel or condominium including various kind of industrial uses where both high delivery rate and head are required.
- ปั๊มน้ำใบพัดเดี่ยวสำหรับส่งน้ำปริมาณปานกลาง เหมาะสำหรับใช้สูบส่งทั้งในงานก่อสร้าง เกษตรกรรม อุตสาหกรรม หรืองานทั่วไป เช่น งานประปา ชลประทาน สปริงเกอร์รดน้ำต่างๆ ระบบส่งน้ำอัตโนมัติ ระบบแรงดันสูงสำหรับหอพัก อพาร์ทเมนต์ โรงแรม หรือคอนโดมิเนียม รวมถึงการใช้งานในโรงงานที่ต้องการทั้งปริมาณน้ำและแรงดันน้ำสูง

Special Features

- Model ACM-375SH, ACM-755SH, ACM-755TH, ACM-755S, ACM-755T, ACM-1105S and ACM-1105T approved for Thai Industrial standard with Electric Pumps-Safety Requirements TIS no.1548-2551
- ผลิตภัณฑ์รุ่น ACM-375SH, ACM-755SH, ACM-755TH, ACM-755S, ACM-755T, ACM-1105S และ ACM-1105T ได้รับอนุมัติให้แสดงเครื่องหมายมาตรฐานกับผลิตภัณฑ์อุตสาหกรรมเครื่องสูบน้ำไฟฟ้า เฉพาะด้านความปลอดภัย มาตรฐานเลขที่ มอก.1548-2551
- Stainless Steel (SUS304) welding impeller :
- Aluminium Frame Motor : Except model WCM-1505S/ T/ FS/ FT WCM-2205S/ T/ FS/ FT and WCM-3705FS/ FT was Steel Frame Motor.



Rust-proof and smooth surface provide high pump efficiency.

ปลอดภัย มีผิวเรียบลื่น ลดแรงเสียดทานในการหมุน และมีประสิทธิภาพสูง



The best heat transfer and light weight properties.

โครงมอเตอร์ทำจากอลูมิเนียม ระบายความร้อนได้ดี และมีน้ำหนักเบา

Hydraulic Performance Curve

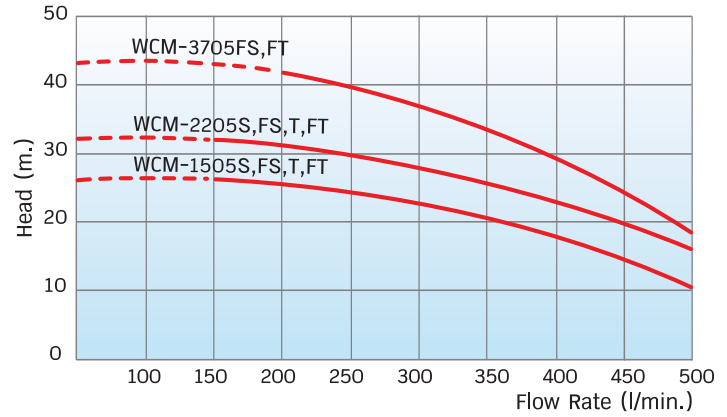
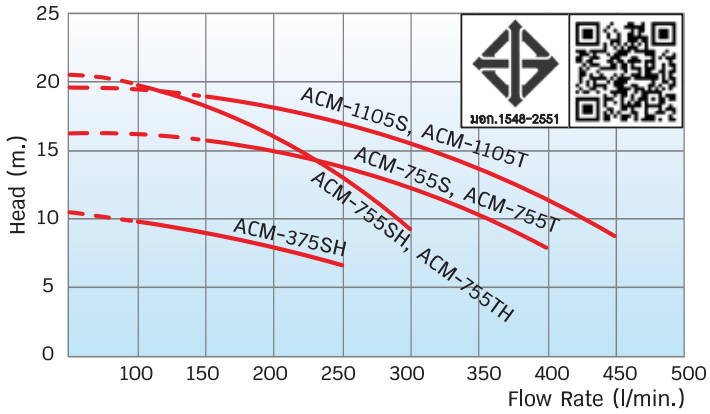

Performance Specifications

MODEL	HP	Max. Current(A)			FLOW RATE	m ³ /Hr.	TOTAL HEAD (m.)										1101.1548-2551	
		1Ø, 220V	3Ø, 220V	3Ø, 380V			0	6	9	12	15	18	21	24	27	30		
1Ø, 220V 50Hz	3Ø, 220/380V 50Hz					l/min.	0	100	150	200	250	300	350	400	450	500		
ACM-375SH	-	0.5	3.2	-	-		10.2	9.3	8.3	7.3	6.6	-	-	-	-	-	-	✓
ACM-755SH	ACM-755TH	1	7.3	5.0	2.9		20.7	19.6	18.3	16.2	13.3	9.6	-	-	-	-	-	✓
ACM-755S	ACM-755T	1	7.3	5.5	2.9		16.4	-	15.9	15.1	14.0	12.5	10.6	8.3	-	-	-	✓
ACM-1105S	ACM-1105T	1.5	9.3	5.9	3.5		19.6	-	19.0	18.2	17.2	15.7	14.0	11.9	9.3	-	-	✓
WCM-1505S,FS	WCM-1505T,FT	2	14.0	8.5	5.0		26.4	-	27.1	25.0	24.0	23.0	21.5	17.4	14.1	10.9	-	-
WCM-2205S,FS	WCM-2205T,FT	3	16.5	10.0	6.3		32.2	-	32.7	30.7	29.7	28.0	26.2	22.0	21.3	14.9	-	-
WCM-3705FS	WCM-3705FT	5	23.5	15.0	8.7		43.0	-	-	41.2	39.4	37.0	33.7	29.4	24.4	18.2	-	-

Above performance data are intended for continuous work with water 20°C temperature and 1 kg/cm³ density, kinematics viscosity 1 mm²/s, atmospheric pressure (100 kPa). Tolerance of the performance curves according to ISO 2548 - class C - ANNEX B.

Dimensions

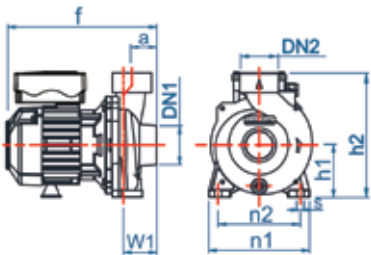

ACM-375SH

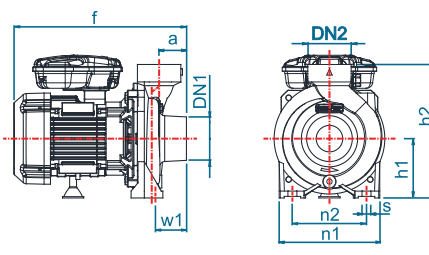

ACM-755SH/ ACM-755S/ ACM-1105S

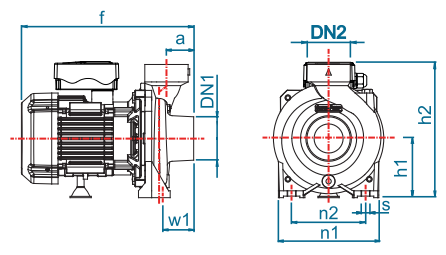

ACM-755TH/ ACM-755T/ ACM-1105T

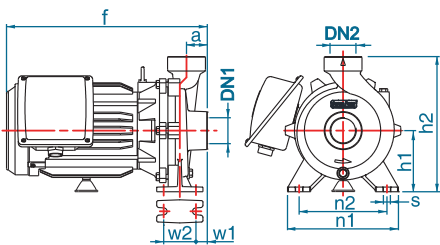

WCM-1505S/ WCM-1505T/ WCM-2205S/ WCM-2205T

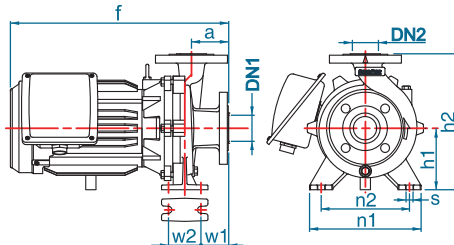

WCM-1505FS,FT/ WCM-2205FS,FT

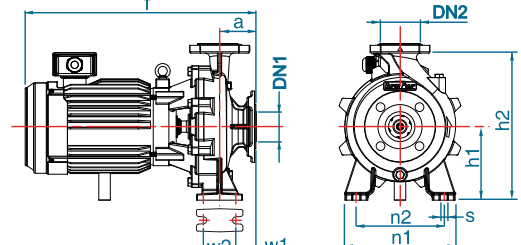

WCM-3705FS,FT

MODEL	BORE SIZE (Inch)	DIMENSIONS (mm.)										WEIGHT (kg.)		
		DN1	DN2	a	f	h1	h2	n1	n2	w1	w2	s	1Ø	3Ø
ไฟสองสาย(1Ø)	ไฟสามสาย(3Ø)													
ACM-375SH	-	1 1/2"	1 1/2"	39	253.5	85	203	165	135	39	-	12	8.8	-
ACM-755SH	ACM-755TH	1 1/2"	1 1/2"	45	319.7	112	252	190	140	52	-	15	16.0	16.0
ACM-755S	ACM-755T	2"	2"	51.5	326.2	112	252	190	140	58.5	-	15	16.0	16.0
ACM-1105S	ACM-1105T	2"	2"	51.5	326.2	112	252	190	140	58.5	-	15	17.1	16.0
WCM-1505S	WCM-1505T	2"	2"	45	434.5	132	292	240	190	59.5	70	15	40.0	38.6
WCM-1505FS	WCM-1505FT	2"	2"	80	469.5	132	292	240	190	59.5	70	15	50.2	48.8
WCM-2205S	WCM-2205T	2"	2"	45	434.5	132	292	240	190	59.5	70	15	40.3	38.9
WCM-2205FS	WCM-2205FT	2"	2"	80	469.5	132	292	240	190	59.5	70	15	50.5	49.1
WCM-3705FS	WCM-3705FT	2"	2"	80	503.3	160	340	240	190	45	70	15	58.3	55.0

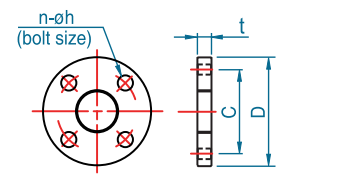

BORE SIZE (Inch)	C	D	t	n	h	BOLT SIZE
1 1/2"	105	140	20	4	19	M16
2"	120	155	20	4	19	M16